

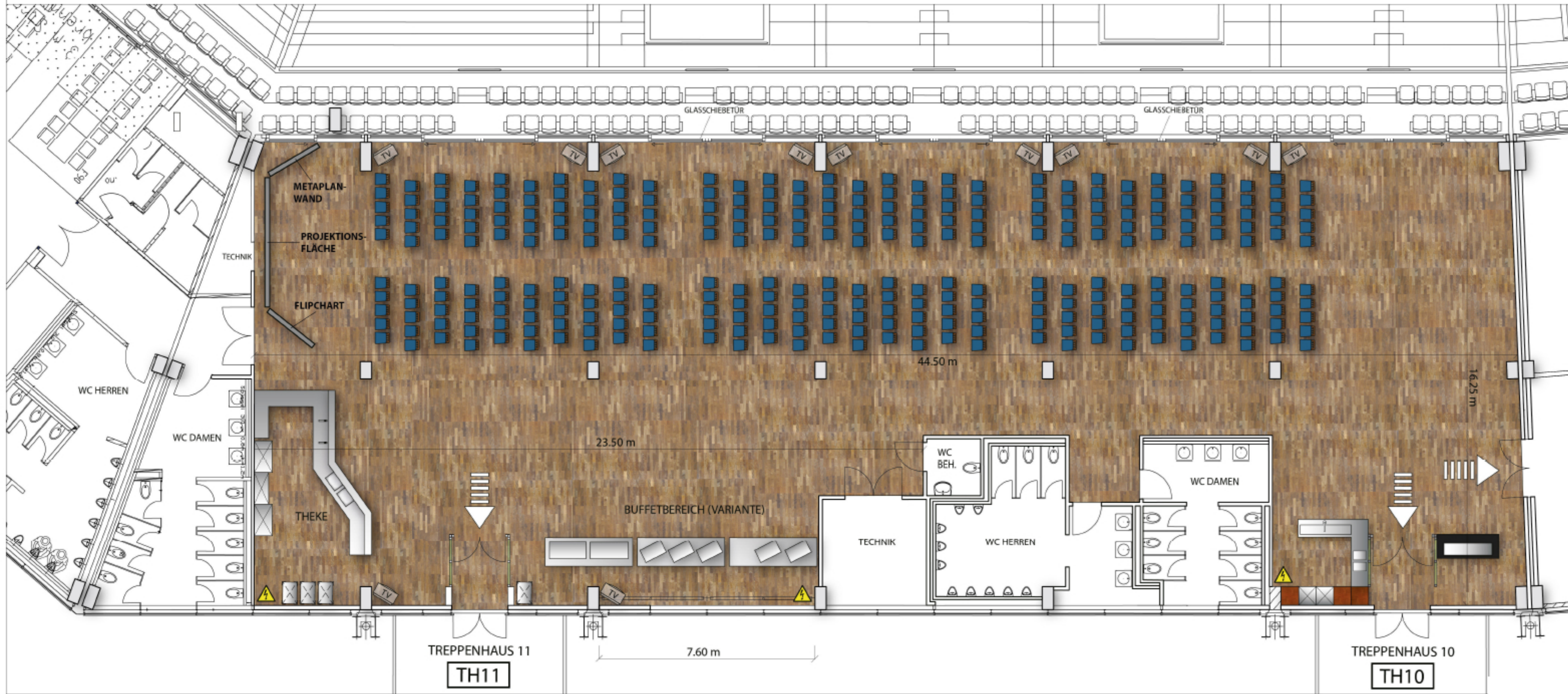

Tibulsky M 1:100 (1cm = 1m)

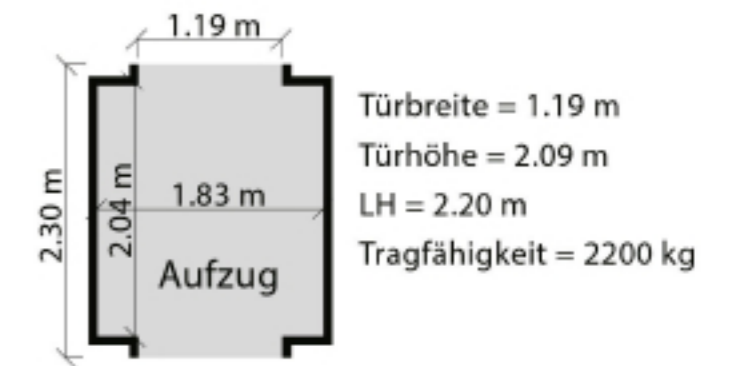

Lageplan (Zugang über Treppenhaus 10)

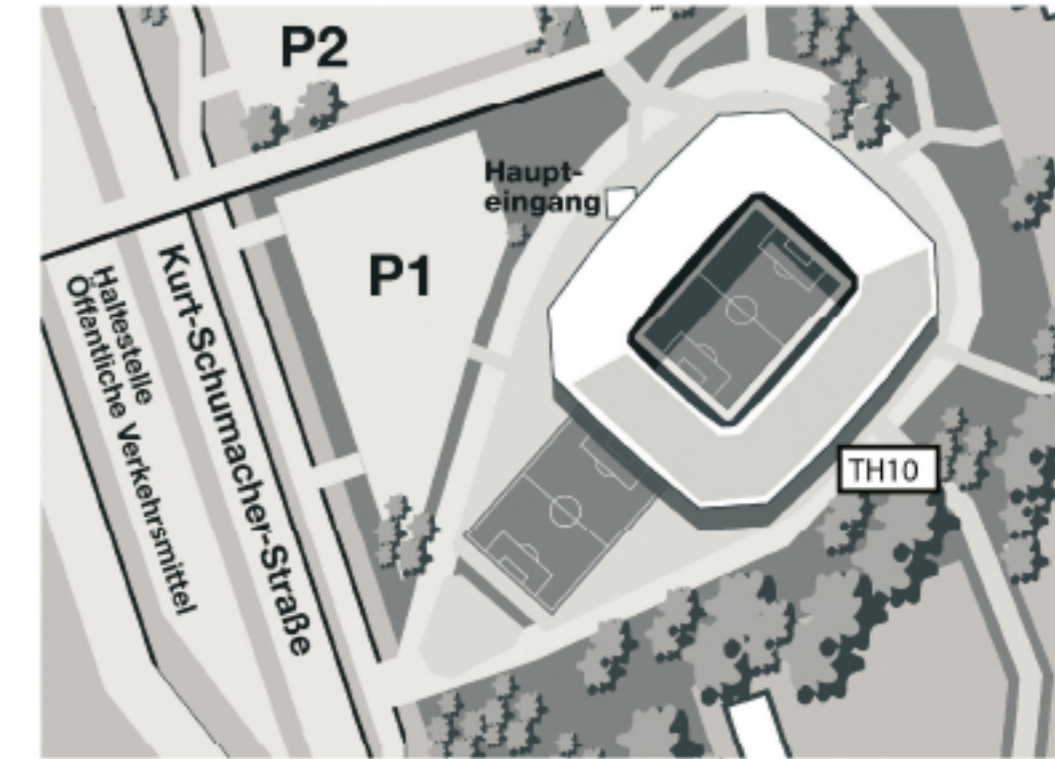

 2 Starkstromanschlüsse à 415V, 32A/16A
4 Schuko-Steckdosen à 230V

FC Gelsenkirchen-Schalke 04 e.V.
Ernst-Kuzorra-Weg 1
45891 Gelsenkirchen
Telefon +49 180 622 1904 *
Fax +49 209 3618-599
kundenservice@schalke04.de
www.schalke04.de
www.veltins-arena.de

* 0,20€ pro Anruf aus dem dt. Festnetz,
Mobilfunk max. 0,60€ pro Anruf